

THE COMMUNITY MENTAL HEALTH EDUCATION PROJECT OF JFS
& ACCESS AT MILWAUKEE AREA TECHNICAL COLLEGE
Present...

WHAT YOU NEED TO KNOW:
NAVIGATING THE MENTAL HEALTH SYSTEM
IN GREATER MILWAUKEE

For mental health professionals, interested community members,
consumers, students, families and supporters.

Friday, November 5, 2010
8:00 a.m. - 1:00 p.m.
Milwaukee Area Technical College
Downtown Campus - Main building, Room M605
1015 N. 6th Street
Milwaukee, WI 53233

This conference consists of 3.5 hours of education and training that may be
applicable for CE Hours depending upon your specific professional requirements.

FREE & OPEN TO THE COMMUNITY

A panel of experts from social service, advocacy, legal, medical, education
and legislative communities will discuss ways to find and access mental health
benefits, services and treatment in the Greater Milwaukee area using case studies
detailing the experiences of three individuals in our community.

FOR MORE INFORMATION PLEASE CONTACT NORMA GILSON AT JFS: 414-390-5800 OR NGILSON@JFSMILW.ORG,
OR AMY WALDMAN AT MATC : 414-297-8418 OR WALDMANA@MATC.EDU



JFS is a partner agency of the Milwaukee Jewish Federation
& a beneficiary of the United Way.



MILWAUKEE
JEWISH FEDERATION

MILWAUKEE AREA *Technical College*



PLEASE TURN OVER FOR
REGISTRATION FORM AND OTHER INFO

NAVIGATING THE MENTAL HEALTH SYSTEM

Friday, November 5, 2010
8:00 a.m. – 1:00 p.m.
Milwaukee Area Technical College | Downtown Campus

REGISTRATION FORM

Please Register by Friday, October 22nd

Name(s) _____

Organization/Agency _____

Address _____

City _____ State _____ Zip _____

Phone _____ E-mail _____

MAIL REGISTRATION TO: COMMUNITY MENTAL HEALTH EDUCATION PROJECT
JEWISH FAMILY SERVICES, INC.
1300 North Jackson Street
Milwaukee, Wisconsin 53202
Attn: Norma Gilson

FAX REGISTRATION: (414)390-5808

PHONE RESERVATION LINE: (414) 225-1373

I am unable to attend but please include me on the mailing list for future programs.

*An interpreter for the deaf and hard of hearing will be provided. Please notify Norma Gilson of any other disability-related accommodation requests ASAP. We will make every attempt to honor these requests if received by October 22nd.
For the safety and comfort of those with chemical and environmental sensitivities, we request that persons attending this training come fragrance free.*

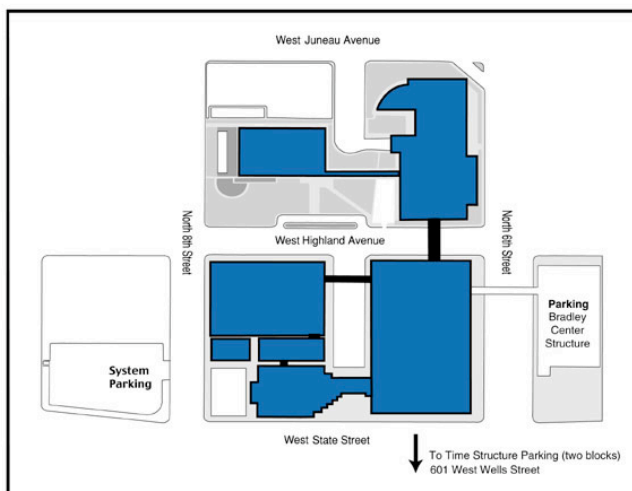

Parking available at the Bradley Center
or nearby surface lots.

The Milwaukee Public Transit System has several buses that stop at or near the MATC. For more info, please visit:
<http://www.ridemcts.com> or call 414-344-6711
(TTY for Hearing Impaired - 414-937-3299)

Please contact Norma Gilson for more information at (414) 390-5800 or ngilson@jfsmilw.org